

miniplus FF06

Rinsable fine filter

Product specification sheet

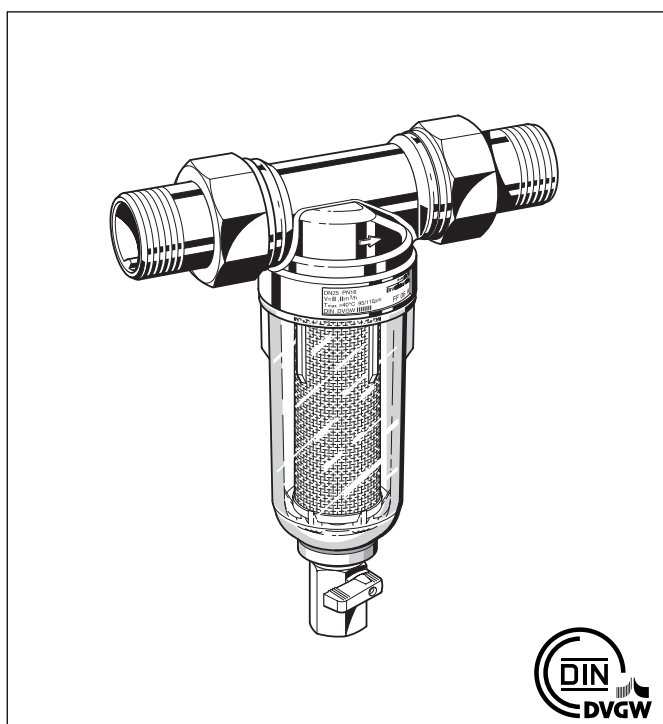

Construction

The fine filter comprises:

- Housing with female and male threads
- Threaded connections (version AA)
- Fine filter in clear filter bowl
- Ball valve

Materials

- Body of dezincification resistant pressed brass
- Brass threaded male connections
- Stainless steel fine filter
- Shock-resistant, clear synthetic material filter bowl

Application

Rinsable miniplus fine filters ensure a continuous supply of filtered water. The fine filter stops the flow of particulates, for example rust particles, strands of hemp, or grains of sand. Sediment collected at the bottom of the filter bowl can simply be removed by flushing with the flick of a finger.

Compact in size, these filters were designed to fit where space is limited.

Special Features

- DIN/DVGW tested
- Easy installation
- Continuous supply of filtered water, also during rinse cycle
- Shock resistant clear synthetic material filter bowl enables easy inspection of filter contamination
- Filter bowl and sieve easily exchanged
- Also available without connections
- Body with female and male threads
- Reliable and tested
- Meets KTW requirements

Range of Application

Medium Water

Technical Data

Installation position	Horizontal with filter bowl downwards
Operating pressure	Maximum 16.0 bar
Operating temperature	Maximum 40 °C
Connection sizes	1/2", 3/4", 1", 1 1/4"

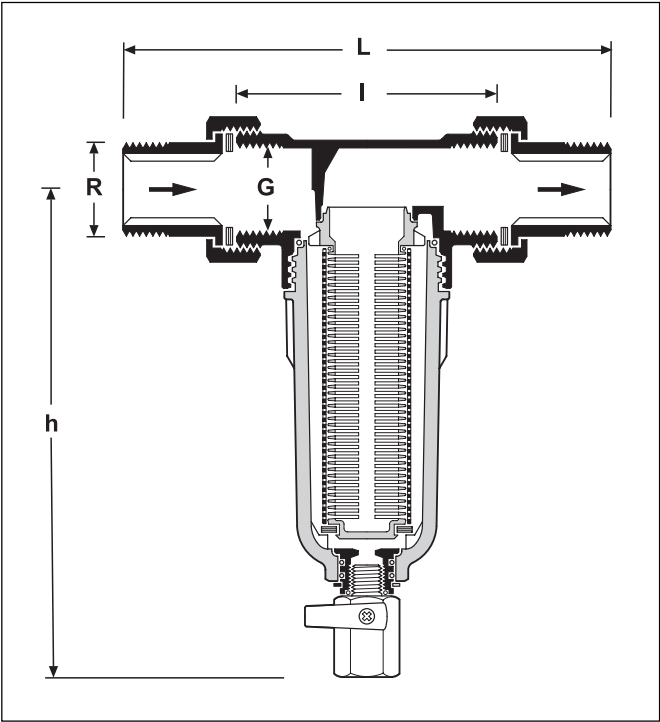

Method of Operation

The mini**plus** fine filter is composed of a body and a rinsable fine filter insert. During normal operation, water flows through the filter mesh to the body outlet. To rinse the filter, the ball valve is opened which discharges the dirt particles. A continuous supply of filtered water is available also during the rinse cycle.

Options

FF06- ... AA = Threaded male connections, filter
lower/upper mesh size 105/135 µm

Connection size

Connection size	R	1/2"	3/4"	1"	1 1/4"
Female thread	G	1/2"	3/4"	1"	-
Approximate weight	(kg)	0.7	1.0	1.3	1.5
Dimensions	(mm)				
	L	140	158	179	197
	I	80	90	100	105
	h	158	180	180	180
Flow rate at Δp = 0.2 bar	(m³/h)	1.5	2.8	3.2	3.8
kvs-value		3.3	6.3	7.2	8.5
DIN/DVGW-Reg. No.		NW - 9301 AT 2530			-

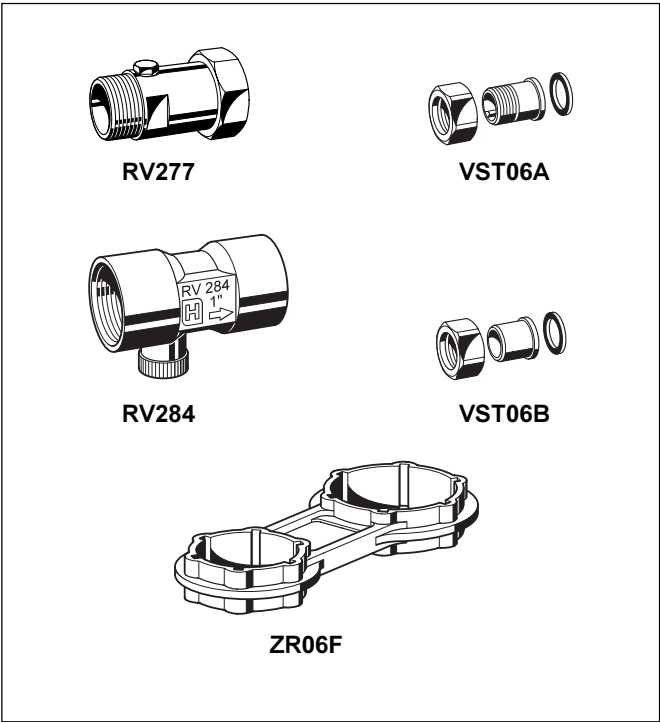

Accessories

ZR06F Double ring wrench

For removing filter bowl

RV277 Inlet non-return valve

For filter sizes 3/4", 1", 1 1/4"

RV284 Non return valve

For filter sizes 1/2" - 1"

VST06 Connection set

With threaded or soldered unions

A = Threaded tailpiece

B = Soldered tailpiece

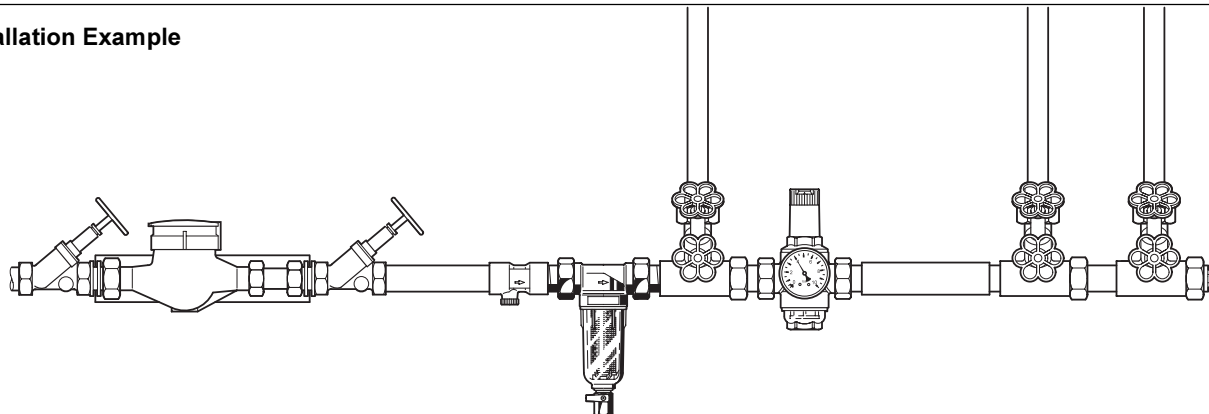
Installation Example**Installation Guidelines**

- Install in horizontal pipework with filter bowl downwards
 - This position ensures optimum filter efficiency
- Fit shut-off valves
- Ensure good accessibility
 - Degree of contamination can well be seen through clear filter bowl
 - Simplifies maintenance and inspection
- Fit immediately after water meter

Typical Applications

mini**plus** fine filters are suitable for all types of household installations. They can also be used for commercial and industrial applications within the limits of their specifications.

FF06 fine filters are installed:

- Where no pressure reducing valve is required (maximum 5.0 bar static pressure)
- Where a pressure reducing valve is already fitted but cannot be retrofitted with a filter

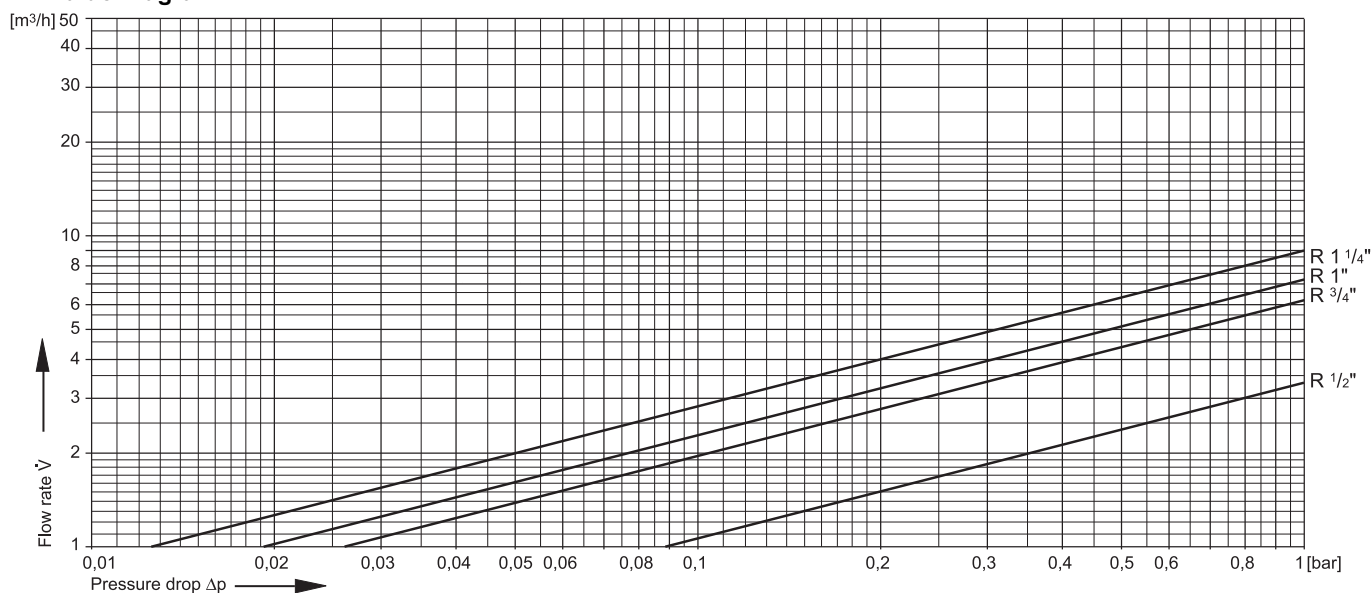
kvs-value Diagramm

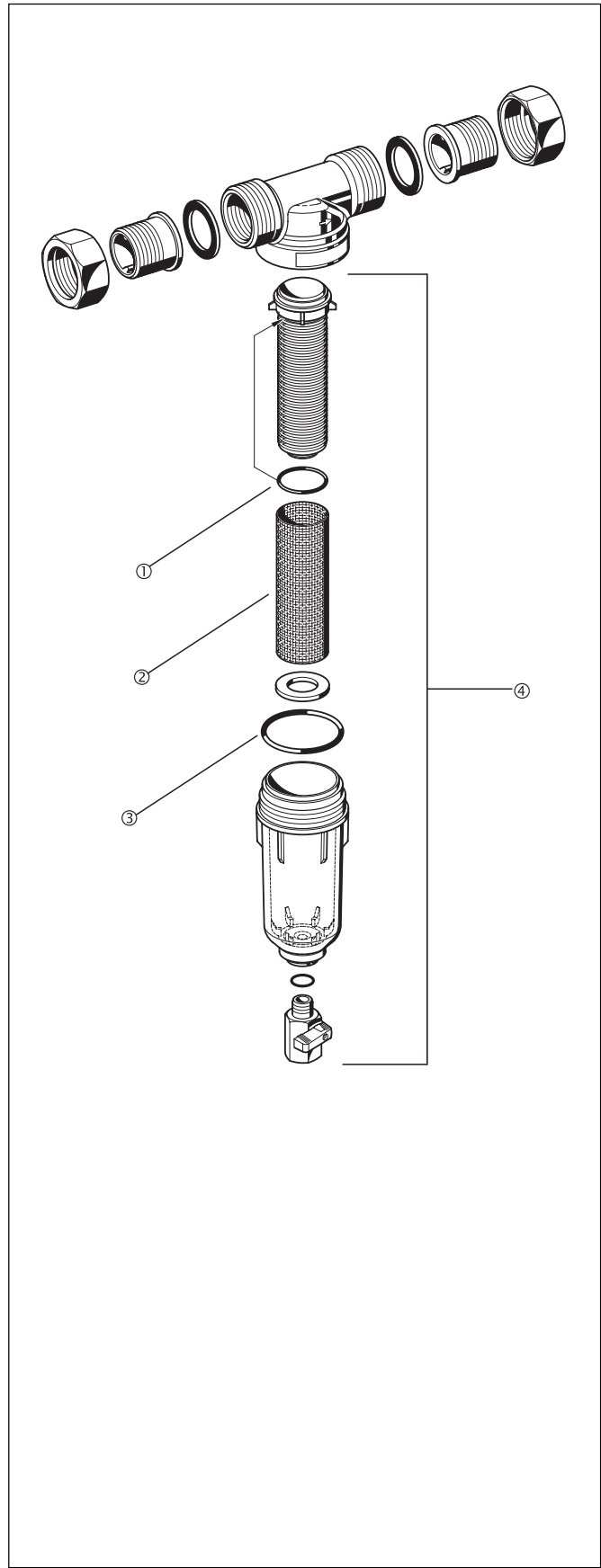

Spare Parts for miniplus** FF06 Fine Filters
(From 1997 onwards)**

Description	Nominal size	Part number
① O-ring set for mesh carrier (pack of 10)	1/2" 3/4" - 1 1/4"	0903127 0903128
② Replacement sieve	1/2" 3/4" - 1 1/4"	AS06-1/2A AS06-1A
③ O-ring set for filter bowl (pack of 10)	1/2" 3/4" - 1 1/4"	0901246 0901499
④ Clear filter bowl complete with sieve and mesh carrier	1/2" 3/4" - 1 1/4"	KF06-1/2A KF06-1A

Honeywell
Braukmann

Automation and Control Products

Honeywell GmbH
Hardhofweg
D-74821 Mosbach

Phone: (49) 6261 810
Fax: (49) 6261 81309
braukmann@honeywell.com

<http://europe.hbc.honeywell.com>